

THE SOLUTION

FLEXCOAT

R-23 FLEX

Osmolastic AB



A Flexible 2-Part Cementitious Waterproofing System

- Cement-Based compatible with most Tile Adhesive
- Non-Toxic Safe for Drinking Water
- Exterior and Interior Use
- Accommodates Movement of ALC Blocks

FLEXCOAT R-23

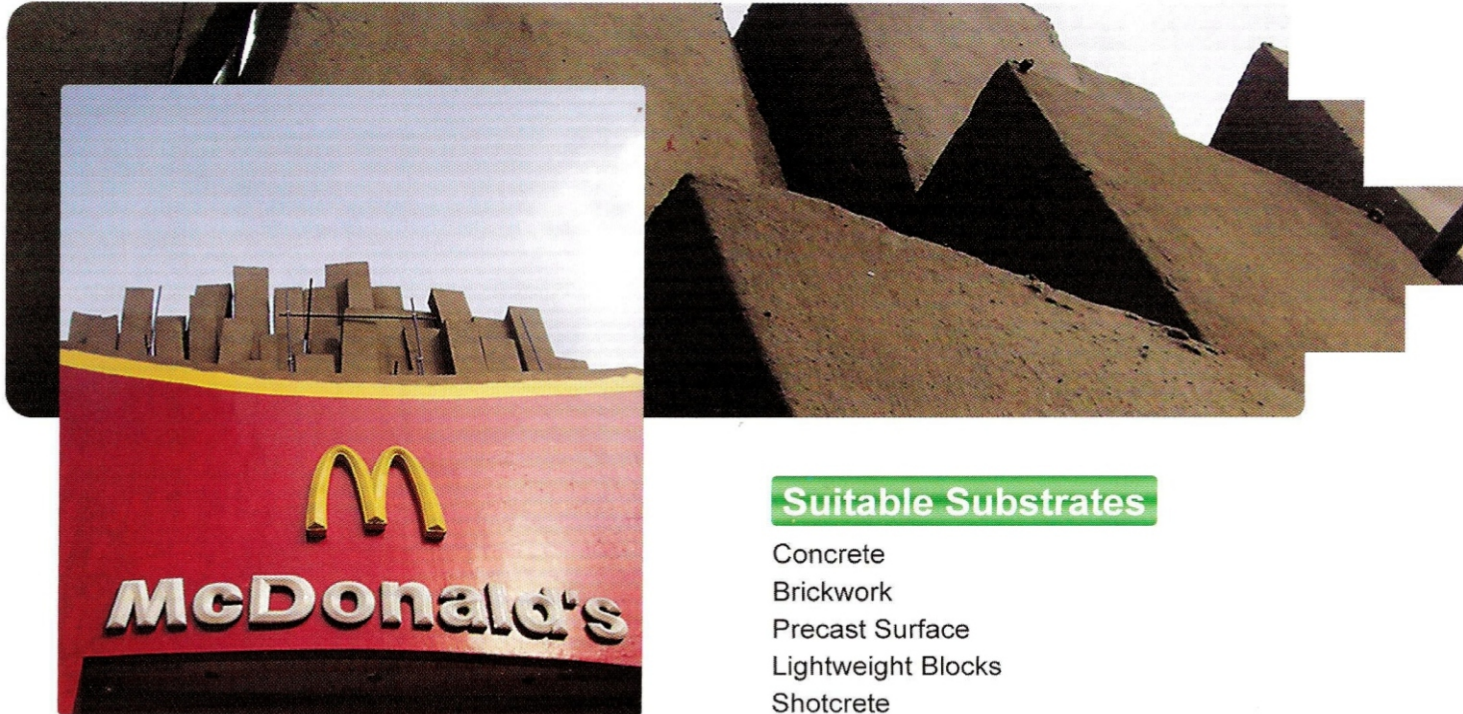

Description

Flexcoat R-23 is a flexible 2-part acrylic-modified cementitious waterproofing system. The 2-components of Flexcoat R-23 Flex reacts chemically after mixing to form a hard and elastic film which bonds tenaciously to most concrete or masonry substrates to protect against possible ingress of water.

The application of Flexcoat R-23 Flex requires the surface to be saturated or wetted down prior to its application. This makes Flexcoat R-23 Flex a practical and ideal product for waterproofing in damp conditions such as basements, wet areas and external areas, of most sites where the surface has to be prewashed prior to applying any waterproofing system.

In external areas, application of Flexcoat R-23 Flex is not affected by change in weather conditions.

Flexcoat R-23 Flex can receive direct plaster or screed without affecting bond. Marbles and tiles can be fixed directly onto Flexcoat R-23 Flex with most types of adhesive.

Flexcoat R-23 Flex can accommodate sufficient movement of structure up to 2 mm. width. Flexcoat R-23 Flex can be used as a repair material for bridging cracks in substrate or cracks due to shrinkage.

Suitable Substrates

Concrete
Brickwork
Precast Surface
Lightweight Blocks
Shotcrete

Advantages

- 2 Component eliminates risk of Incorrect Mixing Ratio
- Seals Lightweight Aerated Blocks
- Seals Precast Joints
- Anti-Carbonation Protection
- Non-Toxic
- Will not attack metal
- No protection required prior to fixing other types of finishes

Surface Preparation

Clean the substrate of any protrusions or substances that may damage the membrane. Ensure all surfaces are free from dirt, dust, grease, oil, wax, curing compounds and any other loose contaminating materials.

Fill all voids, cracks, edges and angles with Seal Grout 60 or suitable repair material, so that the prepared surface is sound, even and clean.

APPLICATION OF R-23 FLEX (Cementitious Waterproofing Membrane for Exterior/Parapet Walls)

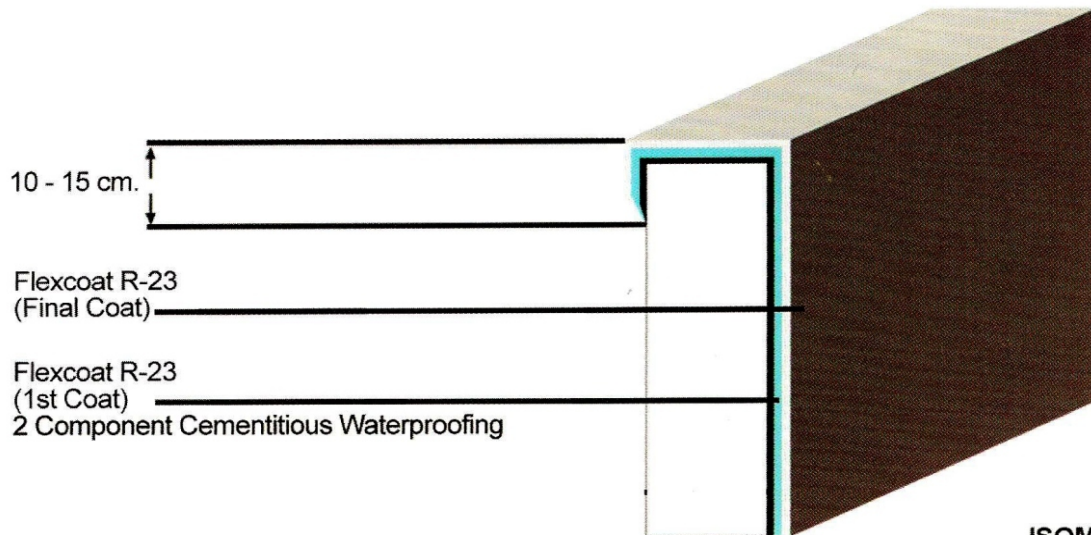

ISOMETRIC DETAIL

Mixing & Application

Put Flexcoat R-23 Flex Liquid into a clean mixing container. Add the Flexcoat R-23 Flex Powder gradually while mixing until a lump free plastic consistency is achieved. **NO ADDITION OF WATER IS ALLOWED.** It is recommended to use mechanical mixing (400-500 rpm) for 2-3 mins. to ensure proper dispersion of the components.

Prewet the surface with clean water. Do not allow pooling or ponding. Very porous surface must be primed with Flexcoat R-Primer prior to applying R-23 Flex. Apply the mixed material onto the prepared surface using a block brush, squeegee or roller in a stiffling action. Apply 1-2 coats finish depending on site conditions and film thickness required. If a trowel is used for application, all undulating or uneven areas must be patched to level before applying the Flexcoat R-23 Flex to prevent the material from building up too thick in one application.

If a 2nd coat is applied, the 1st coat must be left dry tacky approximately 2-3 hours depending on the thickness, substrate porosity and the temperature. If overcoating is done more than 24 hours after applying the previous coat, or the previous coat has already dried out, the surface must be prewetted again.

Note: If applied directly onto lightweight aerated blocks the blocks must be primed with Flexcoat Block Primer until a coloured tint is visible.

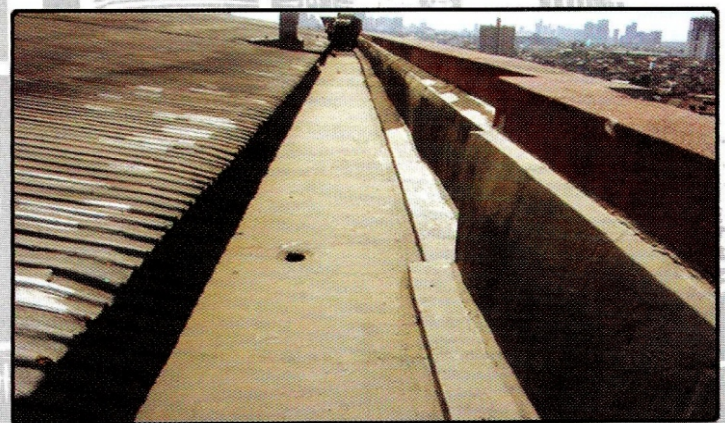

Technical Data

Tensile Strength	> 1.56 N/mm ²	ASTM D 41 2-92
Elongation at Break	> 172%	ASTM D 41 2-92
Adhesion to Concrete	1.18 N/mm ²	ASTM D 4541
Flexibility over 25mm diameter mandrel	Passed	
Bridge Cracks up to 2mm	Passed	
Hardness Shore A	> 83	ASTM S2240 :91
Improves Water Resistance of Concrete by more than 7 time at .4kgf/cm ²	Passed	DIN 1048
Water Vapour Transmission	< 25g/m ² 724hrs.	
Chemical Resistance	Passed	0.5% NaOCl 1.0% NHOH 3.5 HCl
Chloride Content	0.01%	
Toxicity BS6920	Passed	
Working Time (30oC)	Aprox. 1hr.	
Drying Time (30oC) Touch Dry	1-3hrs.	

Uses

Apply on interior and exterior surface of wall and slab, swimming pools, kitchens, toilets, balcony, water tanks. External areas parking deck, planter boxes, sealing pre-cast joints and intersection of two concrete elements. Protection to lightweight blocks, hollow blocks, aerated blocks. Anti carbonation protection.

Cleaning

All tools and equipment which should be cleaned immediately with clean water after use. Hardened material can only be removed mechanically.

Health & Safety

Product contains cement which may cause dermatitis. Wear rubber gloves when handling the product. In case of insufficient ventilation, put on suitable respiratory equipment. Do not apply the product when the surface temperature is below 5°C or greater than 45°C. Product is classified as non-hazardous.